

FREE

Style DARK TRANSFER PAPER



Please read the instructions before production

Description : Self-weeding (No Cut) transfer paper for colored fabrics.

Technical Data : Freestyle Dark is made of 1 sheet of FREESTYLE(A) + 1 sheet of FREESTYLE(B).
FREESTYLE(A) is made of a 110 g/m², 120 µm, release paper liner and a 5 g/m², 5 µm laser printable layer. FREESTYLE(B) is made of a 120 g/m², 135 µm hot release liner and a 65 g/m², 55 µm layer of adhesive pigmented polymer.

Equipment : White Toner laser printers OKI
ES7411WT/C711WT/PRO7411WT (A4) - ES9420WT/C920WT/PRO9420WT/PRO8432WT (A3)
+ Heat Press Machine

Suitable for : Colored cotton and other colored natural and synthetic fabrics.
Ideal for t-shirts, shoppers and other fabric objects.

INSTRUCTIONS :



Insert **FREESTYLE(A)** from the printer's by-pass and set to extra heavy paper 1 printing mode (121-188 gr/m²). How to recognize the printing side: the clipped corner of the sheet must **always be on the bottom right side**, for all sizes. **Print in mirror mode.**



MATCHING

Place the pad at the centre of the plate with the blue and white side facing upwards and a sheet of anti-adhesive tissue paper and heat for at least **180"** at **140°C-145°C.**

Place the following over the white portion of the pad:

- FREESTYLE(A)** with the printed side upwards
 - The small paper tag (contained in the box) in a corner.
 - FREESTYLE(B)** (which is slightly smaller than **FREESTYLE(A)**) **with the glue side** on the print
 - A sheet of adhesive-proof tissue paper
- Then press **FREESTYLE(B)** on **FREESTYLE(A)**.

Manual or pneumatic press:

145°C for 30"-40" or **140°C for 60"-70"** - pressure 4atm/medium-high*

We recommend a shorter time only if the lower plate is very hot (has been working non-stop for at least 1 hour).

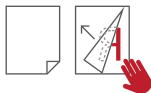

Quickly separate **FREESTYLE(B)** from **FREESTYLE(A)** pinching both the glue sheet and the tissue paper (don't remove the tissue paper). Help yourself with the small paper tag.

*Note: This step is now much easier because the **FREESTYLE(A)** will perfectly adhere to the blue pad.*



Remove pad and place the t-shirt or fabric on the press (heat for a couple of seconds) and then **FREESTYLE(A)** (after having trimmed the edges) with the glue side on the fabric.



APPLICATION

Manual or pneumatic press:

140°C for 28"-30" - pressure 4atm/medium-high



Remove **FREESTYLE(A)** when completely cold with a smooth movement. Press again with adhesive-proof tissue paper for 5"-10" for greater washing resistance.

Store in a cool dry place. | Do not expose to direct sunlight. | If properly stored the product will maintain its features for at least 2 years.